

HENRIKSEN HOOKS

HOOKS
HENRIKSEN HOOKS

HTH

QUICK RELEASE TOWING HOOK

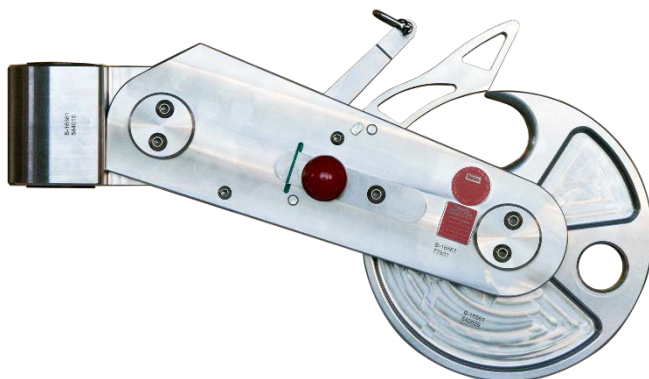

U
S
E
R

M
A
N
U
A
L

Rev.: A3

M000308

HENRIKSEN

REDUCING OPERATIONAL RISK

Phone: +47 33 37 84 00
hooks@hhenriksen.com
www.henriksenhooks.com

HTH

CONNECT

1 Disengage the towing hook from its stowed position to prepare it for the towing operation.

2 Check the following before connecting the end of the towline to the hook:

- the release latch is in closed position (confirmed by the leading line)
- the hook element is in closed position
- the safety latch is in closed position
- the release lever is in its closed position, refer to the illustration
- the hook is free of any impurities or ice

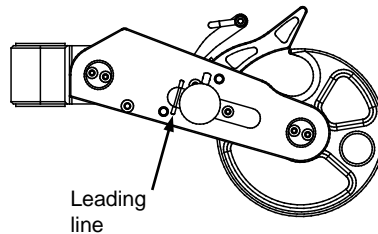
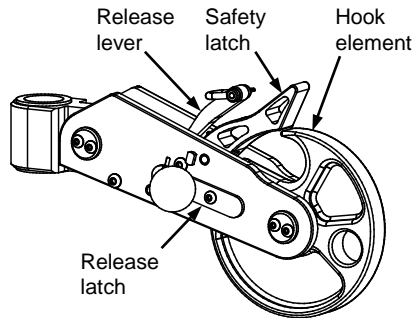

HTH

CONNECT

3 Connect the towline to the hook:

- push the end of the towline between the safety latch and the hook element
- and place it into the jaw of the hook element.

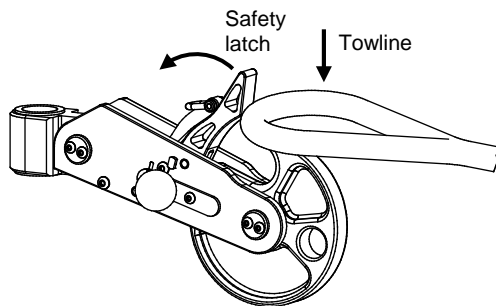

NOTE:

The hook can be used with rope, wire or steel link at the end of the towline.

4 Make sure that the end of the towline is placed properly, and the safety latch is completely locked, refer to the illustration.

The hook is ready for the towing operation.

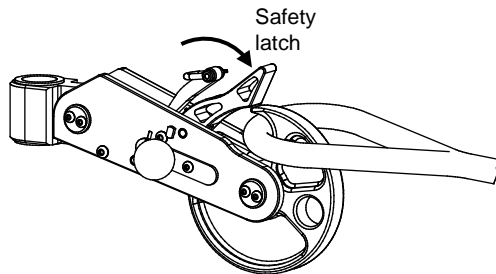

HTH

REMOTE OFF-LOAD RELEASE

Remote release of the towline when there is no load on the hook.

- 1** Make sure that there is no load on the hook.
- 2** Set the release lever to the open position by the remote mechanism and keep the lever in this position.
- 3** Check that the hook element starts to rotate and releases the end of the towline.
Apply load in the direction of towing if necessary to help the rotation.
- 4** When the hook element has released the towline, let the release lever go.

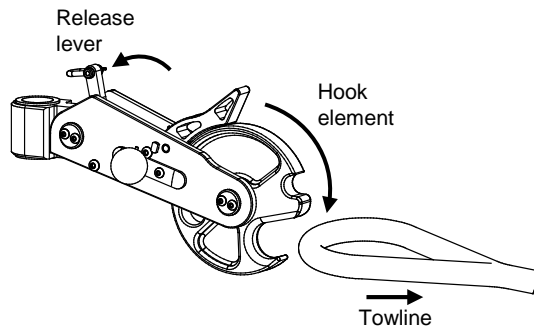

HTH

MANUAL OFF-LOAD RELEASE

Manual release of the towline directly at the hook when there is no load on it.

- 1 Make sure that there is no load on the hook.

- 2 Lift the end of the towline out of the jaw of the hook element by pushing it against the safety latch.

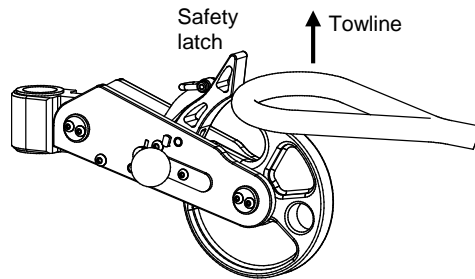

- 3 Release the towline.

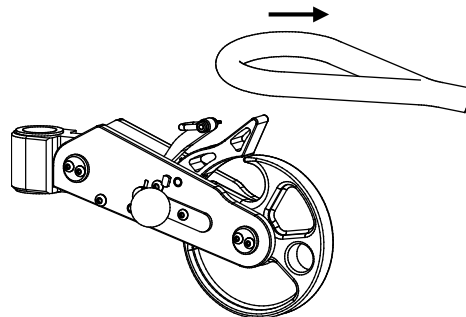

R
E
L
E
A
S
E

HTH

REMOTE ON-LOAD RELEASE

Remote release of the towline when there is a load on the hook. The hook can release up to the full BP of the towing boat.

WARNING: On-load release will cause the towed object, towing boat and the hook to behave in an unpredictable manner. Efforts should be made to reduce the load before release.

- 1** Pull the release lever to the open position by the remote mechanism.

The hook element rotates and releases the end of the towline immediately.

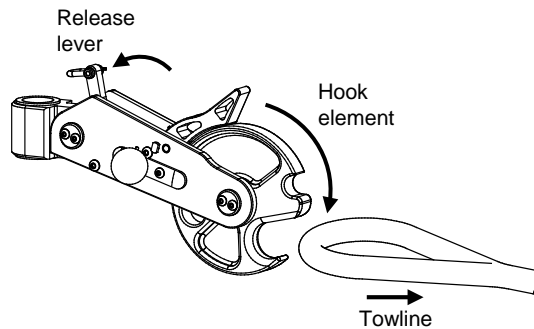

- 2** When the hook element has released the towline, let the release lever go.

HTH

RESET

- 1 Turn the hook element into the closed position, refer to the illustration.

Make sure that the anchoring hole on the hook element is in line with the release latch, refer to the illustration

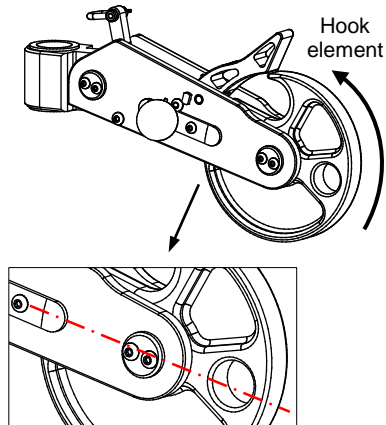

- 2 Hold the hook element in the closed position and push the ball towards the hook element.

The release lever moves to the closed position, confirmed by a click sound.

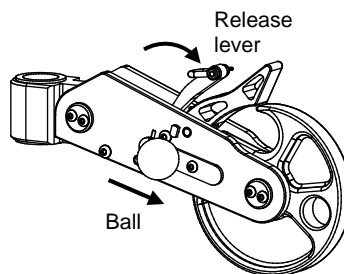

AFTER USE

After use the hook should be stowed away by either securing it to the deck by the use of straps or removing it.



HTH

GENERAL CONSIDERATIONS

- 1 Make sure that the BP of the towing boat is smaller than the WLL of the hook.
- 2 Mount the towing hook on an area that is strong enough to withstand the forces the hook is exposed to.
- 3 Make sure that the mounting bolt has proper material quality and strong enough to withstand the forces the hook is exposed to.

Hook type	Material quality *
HTH 2,5	A4-70 / EN 1.4462
HTH 5	A4-80 / EN1.4410
HTH 10	A4-80 / EN1.4410

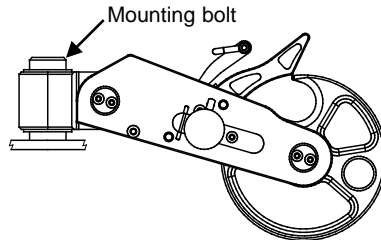

* or equivalent

- 4 The boat shall keep its stability during the towing operation within the operational angles.
- 5 Make sure that the operation angle of the towline is within the operational angle of the towing hook:
 - Vertical: from 0° up to 45°
 - Horizontal: depends on the installation
- 6 Make sure that the hook can swing within the operation angles.

GENERAL CONSIDERATIONS

- 7** Make sure that the remote mechanism is strong enough to operate the release lever and that the operator will be able to apply the force needed to release the hook with the remote mechanism.
The release load on the hook at full WLL: approximately 600 - 900 N.
We recommend to apply a mechanical stopper on the remote mechanism to avoid pulling the release lever over its open position.
- 8** Make sure that the release mechanism can work correctly and the release lever can be operated by the remote mechanism within the operational angle of the towing hook.
- 9** The release lever can retain to its closed position when the remote mechanism is not operated.
- 10** Make sure that the towing hook operator can get access to the towing hook easily and can connect and release the towline safely.
- 11** Use an installation path for the remote cable/wire that prevents tripping hazard.
- 12** Consider prevention against icing on the hook.



HTH

DIMENSIONS

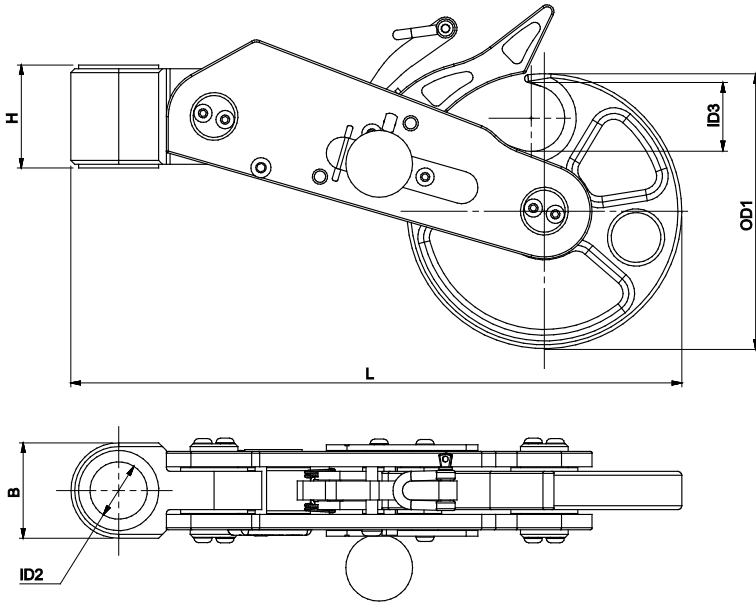

Hook type	HTH 2,5	HTH 5	HTH 10
WLL	2 500 kg	5 000 kg	10 000 kg
L (mm)	320	487	626
H (mm)	54	94	114
B (mm)	50	80	100
OD1 (mm)	Ø144	Ø218	Ø299
ID2 (mm)	Ø30	Ø40	Ø50
ID3 (mm)	Ø35	Ø50	Ø70



HTH

MECHANICAL

- 1** Mount the hook with an adapter onto the boat with bolts or weld the adapter directly to the boat. Make sure that the foundation for the hook is strong enough.

We offer standard certified Henriksen horizontal and vertical adapters. Make sure to apply Loctite 2701 or equivalent on the two locking bolts in case of mounting the hook with a Henriksen vertical adapter.

See the M000614 Quick Reference Guide - HTH Adapter for more details about these adapters.

- 2** Install a remote mechanism to operate the release lever.

FUNCTIONAL TEST

Do a functional test of the following after mounting the hook on the boat:

- Test that the hook can swing within the operational angles.
- Test the function of the remote mechanism up to the full BP of the towing boat.
- Test that the release mechanism can work correctly within the operational angle of the towing hook.
- Check that release lever can retain to the closed position when the remote mechanism is not operated.
- The towline shall be attached simply and safety.
- The towline can be released both on-load and off-load.

We recommend to prevent the hook against any ice to build up.



HTH

- 1** For safety reasons carry out the control in good lighting conditions.



- 2** Remove all impurities (salt, grease, dust, etc.) with fresh water. Remove ice if necessary.



- 3** Check that the following parts are free from deformations and defects:

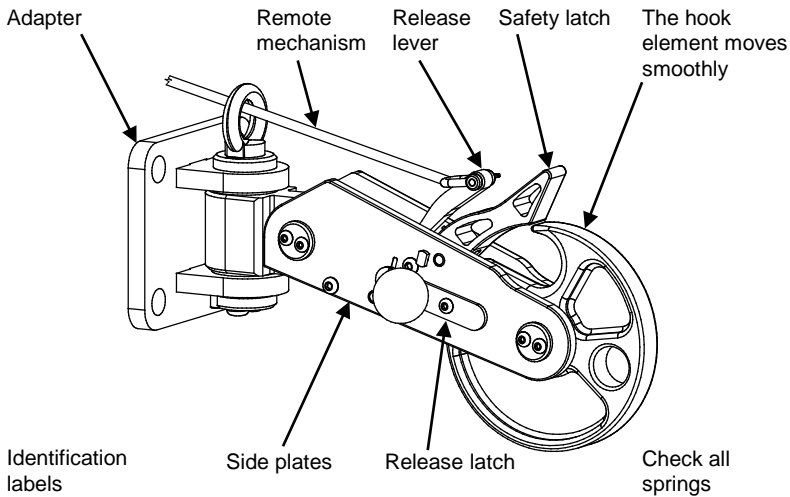

Contact the manufacturer in case of any deviation!

HTH

- 4** Do a functional test of the following:
- Test that the hook can swing within the operational angles.
 - Test the function of the remote mechanism.
 - Test that the release mechanism can work correctly within the operational angle of the towing hook.
 - Check that release lever can retain to the closed position when the remote mechanism is not operated.
 - Check that the towline can be attached simply and safety.
 - Check that the towline can be released both on-load and off-load.
- 5** When the towing hook is not in use, the hook should be stowed away by either securing it to the deck by the use of straps or removing it.

6 DO NOT PAINT ANY PART OF THE HOOK!



Contact the manufacturer in case of any deviation!

HTH

- 1** Towing operations may result in excessive loads being applied to ropes, fairleads, bits and connections. A sudden failure of any element in the towing arrangements may cause death or serious injury to persons.
- 2** The hook is free hanging and can rotate freely within the operational angles when it is disengaged from the stowed position and not connected to the towline. A sudden swinging movement of the hook may cause damage or injury to persons.
- 3** Whilst engaged in towing operations the minimum number of crew essential to carry out duties, is to be on deck, and never exposed to a rope or wire under load.

Wherever possible, a "clear deck" of crew should be in operation whilst towing.
- 4** Taking load on the towline should only be done after all crew members are clear from the aft deck of the towing vessel.
- 5** We recommend to have a minimum tension in the towing line under the towing operation to avoid the end of towing line twisting/wrapping around or disconnect from the hook.

HTH

- 6** Make sure that towing angle is within the operational angles of the hook under the towing operation.
- 7** The towline should normally be released only when there is no load on the hook.
- 8** Ensure that the towline is safely clear from the towing vessel after release, before any engine movements are given.
- 9** If the towing hook is released under load clear deck must apply and all personnel must take a safe stand-by position as uncharacteristic behavior of the boat may occur if the load is significant. Efforts should be made to reduce the load before release.
- 10** The safety latch of the HTH hooks has a hole for an additional safety pin. Setting the pin in this hole will prevent any opening of the safety latch in case of custom towing operations.
- 11** The HTH hooks have an anchoring hole on the hook element that is not recommended for towing operations. When anchored to this hole the hook will not be able to release a load.

**S
A
F
E

U
S
E**